



Kit Contents

	Description	Part No	Pcs
1	Shock absorber front	POV 5Y01	2
2	Helper spring		2
3	Spring support	05193-14	2
4	Main spring		2
5	Top pin spacer	05688-03	2
6	Upper spring seat	06211-01	2
7	Spacer	00426-01	2
8	Preload adjuster tool	03199-01	1
9	Öhlins sticker kit	10207-01	1
10	Öhlins Owners manual	07445-01	1

👁 Note!

Please note that there can be small differences between your product and the images in these instructions.

👁 Note!

Please note that during storage and transport, especially at high ambient temperature, some of the oil and grease used for assembly may leak and stain the packaging. This will not cause damage to the product, wipe off the excessive oil or grease with a cloth.

👁 Note!

Please note that this kit is for track use purpose only! There is an increased risk of noise that could be heard inside the vehicle during usage on open roads.

👁 Note!

Before you install this product, check the kit contents. If anything is missing, please contact an Öhlins dealer.

⚠ Warning!

Before you install this product, read the Öhlins Owner's manual. This product is an important part of the vehicle and the vehicle stability.

👁 Note!

When using aftermarket wheels with different widths and offsets, the use of spacers to clear the suspension may be necessary.

👁 Note!

If the vehicle is equipped with OEM electronic shock absorbers, use Öhlins cancellation kit to avoid error codes. For more information and part number, please visit www.ohlins.com or contact an Öhlins dealer.

Shock absorber kit Advanced Trackday for Porsche 997 GT3/GT3 RS 2007-2011

POV MY00 *front*

Mounting Instructions



MOUNTING INSTRUCTIONS

⚠ Warning!

We strongly recommend to let an Öhlins dealer install this product.

⚠ Warning!

If you work with a lifted vehicle, make sure that it is safely supported to prevent it from tipping over.

👁 Note!

When you work with this product, see the vehicle service manual for vehicle specific procedures and important data.

👁 Note!

Before you install this product clean the vehicle.

1

Raise the vehicle and put it on jack stands.

2

Remove the wheels.

👁 Note!

If the vehicle is equipped with PASM and/or lift system, disconnect the connections. Strap the loose cables/hoses in an appropriate way and make sure to protect the connections with heat shrinkable tube or similar.

3

Loosen the bolt for the lower shock attachments.

👁 Note!

Support the wheel hubs in an appropriate way on each side of the vehicle so that the brake hoses can not be damaged.

4

Loosen the upper attachments. Remove the original shock absorbers from the car.

5

Assemble the front shock absorbers according to figure 1: Install the helper spring (2), the spring support (3), the main spring (4), the top pin spacer (5), the upper spring seat (6), the OEM lower top mount spacer, the OEM top mount and the OEM upper nut. Tighten the nut to the OEM torque specification.

👁 Note!

When tightening the top mount nut, the shock absorber shaft end must be held in position with an allen key.

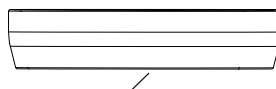
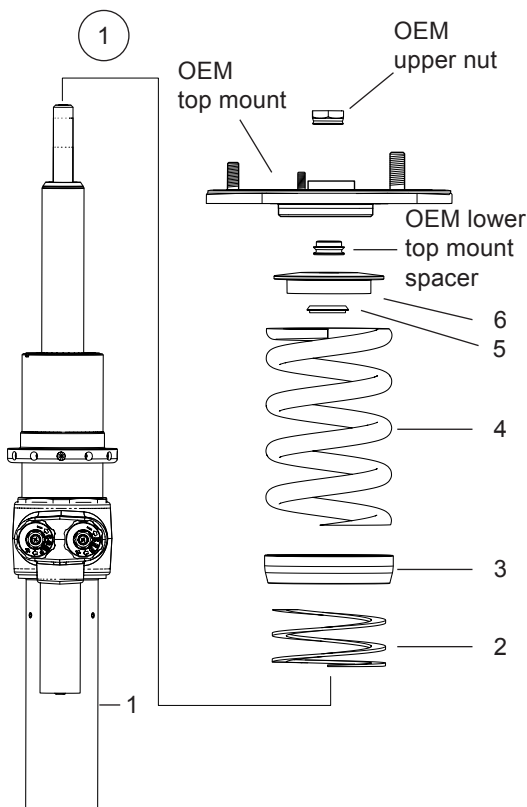

👁 Note!

Please note orientation of the spring support. The smaller diameter should be installed towards the helper spring.

MOUNTING INSTRUCTIONS

6

Install the spacer (7) to gain more space between the OEM cable bracket and the reservoir on the shock absorber according to Fig 3.

7

Fit the shock absorber to the vehicle upright. Position it according to Fig 2 so that the adjusters on the shock absorber are pointing towards the rear of the vehicle. Make sure there is clearance between the upright and reservoir according to fig 4.

8

Tighten the lower attachment.

9

Fasten the upper attachment/top mount to the vehicle.

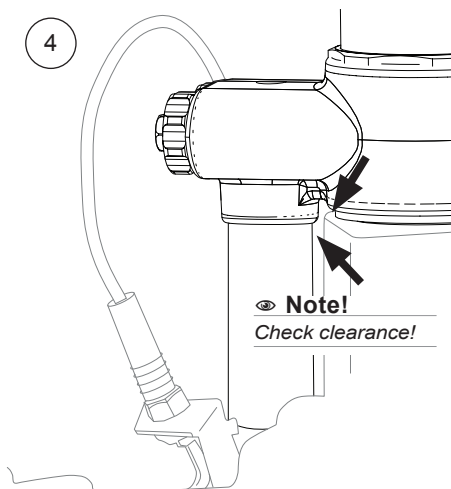
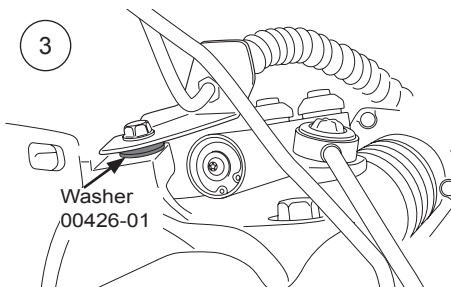
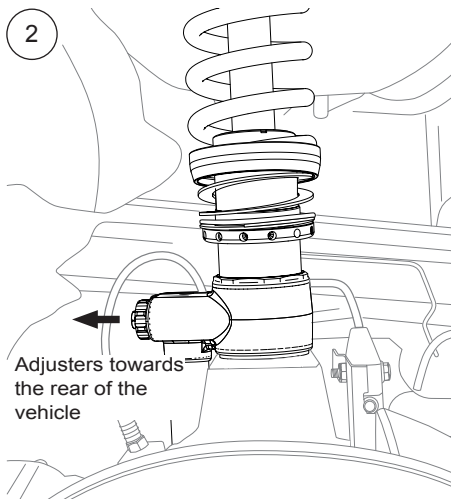

MOUNTING INSTRUCTIONS

13

Make sure that all removed parts are reinstalled in the same way as they were before the installation of the Öhlins shock absorber.

14

Reinstall the wheel.

Note!

Make sure that all bolts are tightened to the correct torque and that nothing fouls or restricts movement of the strut when it is being fully compressed or extended. Test this over the whole steering range from lock to lock.

Some of the original bolts need to be replaced when removed. See the service manual for your vehicle or contact an Öhlins dealer.

Note!

Make sure there is enough clearance between the wheel and the suspension. If using wider wheel options the use of spacers may be necessary.

ADJUSTMENTS

⚠ Warning!

Before you ride/drive, always make sure that the setup is according to the recommended setup data. Read about adjustments and setting up in the Öhlins Owner's Manual before you make any adjustments. Contact an Öhlins dealer if you have any questions about setting up.

SETUP DATA

	Street	Track
Compression damping	15 clicks	10 clicks
Rebound damping	14 clicks	14 clicks

Recommended Springs

Main Spring

Length	Rate	Öhlins#
140 mm	120 N/mm	48140-21

Helper spring

Length	Rate	Öhlins#
73 mm	7.5 N/mm	05173-12

Recommended installed spring package length

187 mm

Measure from upper edge of main spring to lower part of helper spring. Adjust the installed spring package length by turning the spring preload adjuster until desired ride height is achieved.

Depending on car model and equipment, the ride height at the recommended installed spring package length may vary.

⚠ Warning!

Never adjust the spring preload adjuster so that the installed spring package length is shorter than 185 mm. If that is done the spring may coil bind.

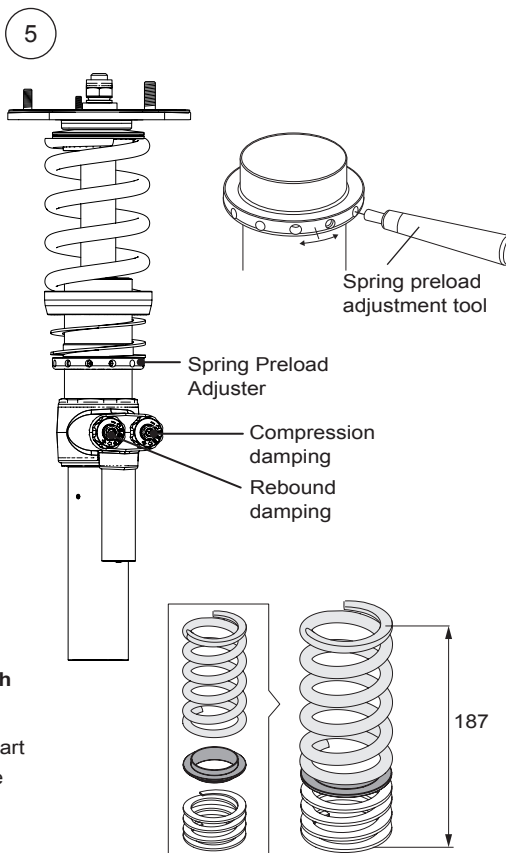

Öhlins products are subject to continuous improvement and development, therefore, although these instructions include the most up-to-date information available at the time of printing, minor updates may occur.

To find the latest information contact an Öhlins distributor. Please contact Öhlins if you have any questions regarding the contents in this document.

Part no. MI_POV MY00_0
Issued 2023-08-30

© Öhlins Racing AB. All rights reserved. Any reprinting or unauthorized use without the written permission of Öhlins Racing AB is prohibited.

Öhlins Racing AB
Box 722
S-194 27 Upplands Väsby, Sweden
Phone +46 8 590 025 00
fax +46 8 590 025 80



www.ohlins.com



Kit Contents			
	Description	Part No	Pcs
1	Shock absorber	POV 6Y00	2
2	Helper spring		2
3	Spring support	05193-07	2
4	Main spring		2
5	Upper spring seat	25618-40	2
6	Lock nut M12x1.25	00539-01	2

Note!

Please note that there can be small differences between your product and the images in these instructions.

Note!

Please note that during storage and transport, especially at high ambient temperature, some of the oil and grease used for assembly may leak and stain the packaging. This will not cause damage to the product, wipe off the excessive oil or grease with a cloth.

Note!

If the vehicle is equipped with OEM electronic shock absorbers, use Öhlins cancellation kit to avoid error codes. For more information and part number, please visit www.ohlins.com or contact an Öhlins dealer.

Note!

Please note that this kit is for track use purpose only! There is an increased risk of noise that could be heard inside the vehicle during usage on open roads.

Note!

Before you install this product, check the kit contents. If anything is missing, please contact an Öhlins dealer.

Warning!

Before you install this product, read the Öhlins Owner's manual. This product is an important part of the vehicle and the vehicle stability.

Shock absorber kit Advanced Trackday for Porsche 997 GT3/GT3 RS 2007-2011

POV MY00 rear

Mounting Instructions



MOUNTING INSTRUCTIONS

⚠ Warning!

We strongly recommend to let an Öhlins dealer install this product.

⚠ Warning!

If you work with a lifted vehicle, make sure that it is safely supported to prevent it from tipping over.

👁 Note!

When you work with this product, see the vehicle service manual for vehicle specific procedures and important data.

👁 Note!

Before you install this product clean the vehicle.

1

Raise the vehicle and put it on jack stands.

2

Remove the wheels.

3

Loosen the bolt for the lower shock attachments.

👁 Note!

Support the wheel hubs in an appropriate way on each side of the vehicle so that the brake hoses can not be damaged.

4

Loosen the upper attachments. Remove the original shock absorbers from the car.

5

Assemble the rear shock absorbers according to Fig 1: Install the helper spring (2), the spring support (3), the main spring (4), the upper spring seat (5), the OEM top mount and the lock nut (6). Tighten the lock nut to 40 Nm.

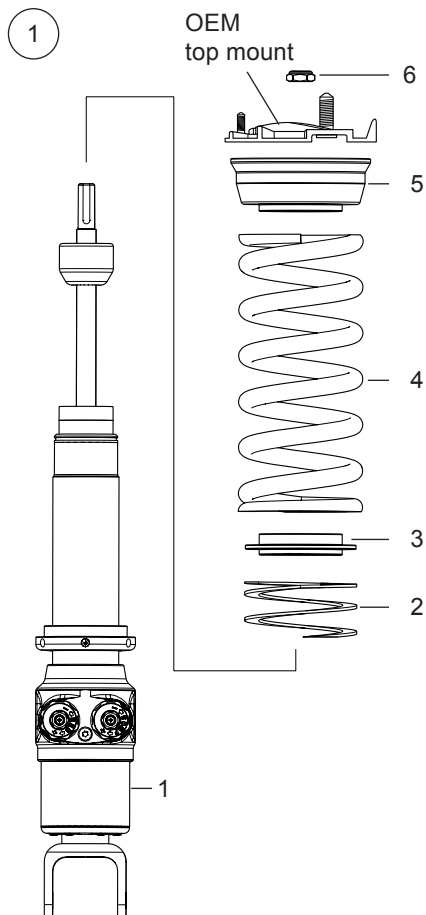

MOUNTING INSTRUCTIONS

6

Install the shock absorber starting with the upper attachments. Position the shock absorber according to Fig 2 with the adjusters pointing towards the inside of the vehicle.

7

Fasten the lower attachment.

Note!

Make sure that all bolts are tightened to the correct torque and that nothing fouls or restricts movement of the strut when it is being fully compressed or extended. Some of the original bolts need to be replaced when removed. See the service manual for your vehicle or contact an Öhlins dealer.

8

Make sure that all removed parts are reinstalled in the same way as they were before the installation of the Öhlins shock absorber.

9

Reinstall the wheel.

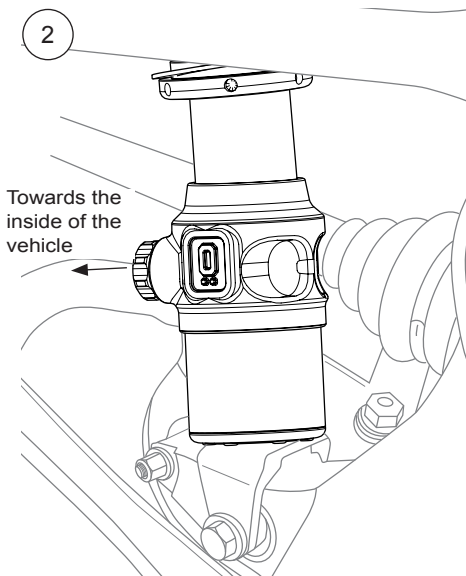

ADJUSTMENTS

⚠ Warning!

Before you ride/drive, always make sure that the setup is according to the recommended setup data. Read about adjustments and setting up in the Öhlins Owner's Manual before you make any adjustments. Contact an Öhlins dealer if you have any questions about setting up.

SETUP DATA

	Street	Track
Compression damping	12 clicks	10 clicks
Rebound damping	15 clicks	10 clicks

Recommended Springs

Main Spring

Length	Rate	Öhlins#
200 mm	170 N/mm	48200-31

Helper spring

Length	Rate	Öhlins#
73 mm	7.5 N/mm	05173-12

Recommended installed spring package length

242 mm

Measure from upper edge of main spring to lower part of helper spring. Adjust the installed spring package length by turning the spring preload adjuster until desired ride height is achieved.

Depending on car model and equipment, the ride height at the recommended installed spring package length may vary.

⚠ Warning!

Never adjust the spring preload adjuster so that the installed spring package length is shorter than 240 mm. If that is done the spring may coil bind.

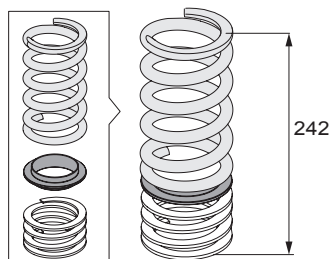
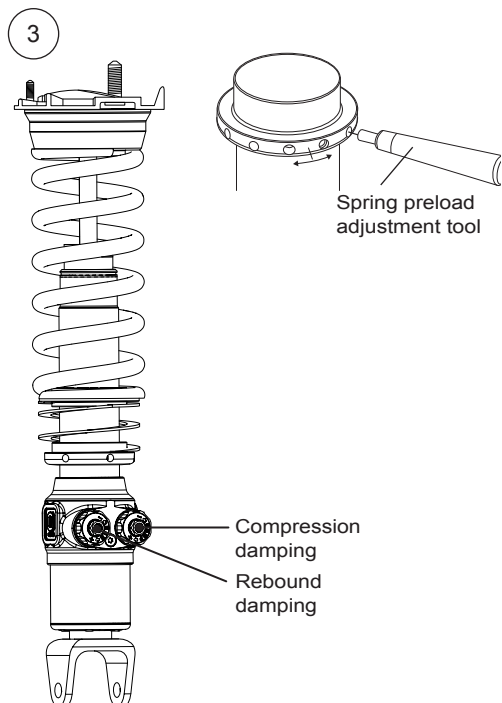

Öhlins products are subject to continuous improvement and development, therefore, although these instructions include the most up-to-date information available at the time of printing, minor updates may occur.

To find the latest information contact an Öhlins distributor. Please contact Öhlins if you have any questions regarding the contents in this document.

Part no. MI_POV MY00_0
Issued 2023-08-30

© Öhlins Racing AB. All rights reserved. Any reprinting or unauthorized use without the written permission of Öhlins Racing AB is prohibited.

Öhlins Racing AB
Box 722
S-194 27 Upplands Väsby, Sweden
Phone +46 8 590 025 00
fax +46 8 590 025 80



www.ohlins.com