

*Front fork*

***RXF38 m.3***

**Owner's Manual**





*Öhlins Headquarters Upplands Väsby, Sweden*

### **Öhlins Racing AB - The Story**

It was the 1970's, a young man named Kenth Öhlin spent most of his spare time pursuing his favourite sport: motocross.

Being a careful observer, Kenth's attention was continuously drawn to one specific detail - motocross bikes had more engine power than their suspension could handle. It was not long before Kenth realised that better performance could be achieved by improved wheel suspension.

Öhlins Racing was established in 1976, and just two years later the company won its first World Championship title. Despite being in the business for almost 40 years, the search for perfection and new functions is still the main focus of the company.

Congratulations! You are now the owner of an Öhlins product. More than two hundred World Championships and other major world titles are definitive proof that Öhlins products offer outstanding performance and reliability.

Every product has gone through rigorous testing and engineers have spent thousands of hours, doing their very best to use every possible experience from our almost 40 years within the racing sport.

The product that you now have in your possession is pure racing breed that is built to withstand.

By installing this product on your bike you have made a clear statement... you are a serious rider with a focus on getting the maximal handling ability and outstanding feedback from your bike. Along comes the fact that your Öhlins product will be a long lasting friend, delivering the very best of comfort and performance every time you go for a ride. Go explore!

# SAFETY PRECAUTIONS

## General Warnings

### **Note!**

*The fork is an important part of the bicycle and will affect the stability.*

### **Note!**

*Read and ensure you understand the information in this manual and other technical documents provided by the bicycle manufacturer before using the product.*

### **Note!**

*Öhlins Racing AB can not be held responsible for any damage to the shock absorber, bicycle, other property or injury to persons, if the instructions for mounting, usage and maintenance are not followed exactly.*

### **Warning!**

*After you have installed the Öhlins product, take a test ride at low speed to ensure that the bicycle has maintained stability.*

### **Warning!**

*If the suspension makes an abnormal noise, or the function is irregular, or if you notice any leakage from the product, stop the bicycle immediately and return the product to an Authorized Öhlins MTB Service Center.*

### **Warning!**

*The product warranty shall only apply if the product has been operated and maintained in accordance with recommendations in this manual. If you have any questions regarding usage, service, inspection and/or maintenance please contact an Authorized Öhlins MTB Service Center.*

### **Note!**

*This manual shall be considered as a part of the product and shall therefore accompany the product throughout its life cycle.*

### **Warning!**

*This product was developed and designed for the bike industry and shall only be installed on to related vehicles, including pedal-assisted motorized cycles that produces a maximum of 250 watts of power. DO NOT use any Öhlins bicycle suspension product on any throttle-equipped motorized cycle or any vehicle carrying more than one operator or rider, such as a tandem bicycle or heavy utility bicycle. Any use outside of these terms must be approved by Öhlins on a case-by-case basis. Any such unauthorized misuse may result in failure of the suspension, which may cause a crash and result in property damage. **SERIOUS INJURY OR DEATH**, and avoid warranty.*

## SAFETY SYMBOLS

*In this manual, mounting instructions and other technical documents, important information concerning safety is distinguished by the following symbols:*



*The Safety Alert Symbol means: Warning! Your safety is involved.*

### **Warning!**

*The Warning Symbol means: Failure to follow warning instructions can result in severe or fatal injury to anyone working with, inspecting or using the Product/Fork, or to bystanders.*

### **Caution!**

*The Caution Symbol means: Special precautions must be taken to avoid damage to the Product/Fork.*

### **Note!**

*The Note Symbol indicates information that is important regarding procedures.*

### **Note!**

*Please retain the original packaging for warranty or service needs.*

### **Note!**

*When working with the Öhlins product, always read the bicycle manufacturer's manuals.*

### **Note!**

*Please note that during storage and transportation, especially at high ambient temperature, some of the oil and grease used for assembling may leak and stain the packaging. This is in no way detrimental to the product, wipe off the excessive oil/grease with a cloth.*

### **Warning!**

*This product contains pressurized air. Do not open, service or modify this product without proper education and proper tools. All hydraulic servicing must be completed by an Authorized Öhlins MTB Service Center. All other servicing must be completed by an Authorized Öhlins MTB Service Center alternatively you can conduct the service yourself if you have the necessary skills, genuine parts and tools. In some cases the product may need to be sent to another region for service.*

### **Note!**

*Please note that the images in this manual are a general representation of the product and may differ slightly from your product.*

# THE ÖHLINS RXF38 M.3 FRONT FORK

Congratulations on your excellent choice of purchasing this high performance Öhlins front fork.

This product is designed for the upcoming, next generation of stars and has been developed by Öhlins' mountainbike department in Sweden, with their experience from the world stars of today.

We recommend you to read this manual carefully for proper bike set up to get the best possible performance out of your suspension components.

## Contents

1 How it works .....	5
2 Mounting instructions .....	6
3 Air spring setup .....	8
4 Coil spring setup .....	11
5 Damper Setup.....	13
6 Maintenance .....	16
7 Service.....	17

# 1 HOW IT WORKS

To get your suspension set up correctly the front fork and shock absorber must be in balance. To achieve this, both must be considered when setting up the new product.

To set up the fork there is two systems to consider.

## **Spring**

The main purpose of the spring is to support the rider and bike and restore the set ride height after impact.

Setting up your sag is the most important aspect of tuning your fork, and this is done by correctly tuning your air or coil spring. Sag is the percentage of suspension travel that is used when you assume normal, static riding position on the bike. See separate chapter for spring setup procedure.

## **Hydraulic damping**

The damping controls the forks movement in compression and in rebound by converting the kinetic energy in to heat. Valves and shim stacks are used to regulate the oil flow and thus controlling the amount of damping.

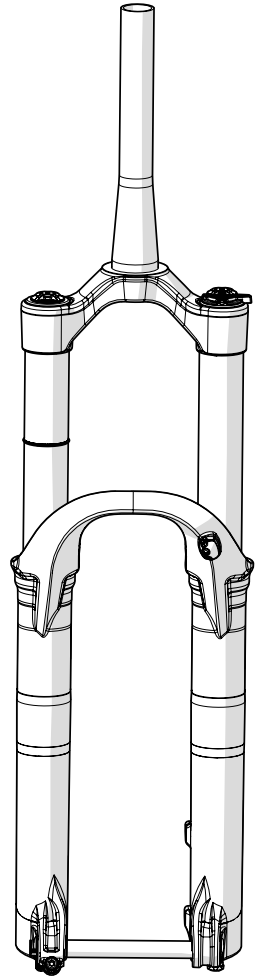

# 2 MOUNTING INSTRUCTIONS

## **⚠ Warning!**

*It is advisable to have an Authorized Öhlins MTB Service Center install the front fork.*

## **⚠ Warning!**

*If the bicycle is mounted in a work stand please make sure to hold the frame when front fork is removed to prevent damage to paint and (or) finish.*

## **👉 Caution!**

*Press fit crown races, e.g. crown races with integrated steerer stop, should be pressed or hammered in to position with the bottom of the steerer tube as the support. The end of the steerer tube must be firmly supported and no other part of the fork is allowed to bear any load during this operation.*

## **👁 Note!**

*Before installing this product clean the bicycle thoroughly.*

**1**

Remove the original front fork.

**2**

Place the front fork. Install stem and tighten headset according to manufacturers' instructions.

**3**

Install the brake caliper according to the brake manufacturer's instructions. Minimum rotor size Ø200 mm, do not use a rotor larger than Ø230 mm.

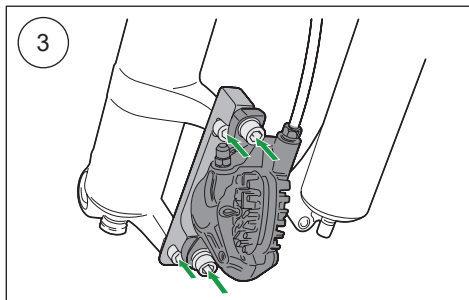
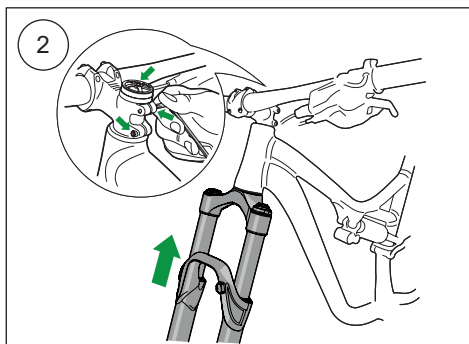
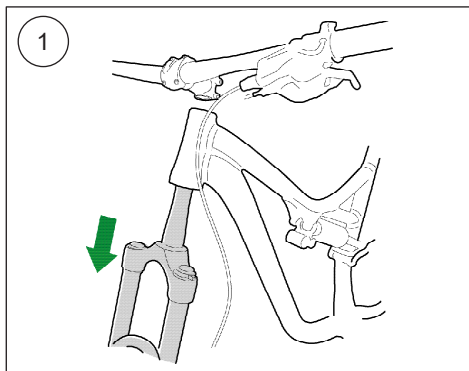

# 2 MOUNTING INSTRUCTIONS

4

Attach the brake cable to the hose clamp and tighten the screw. Use a 2.5 mm Hex wrench. Tighten the bolt to 0.5 Nm.

5

Apply Grease on threads before installation. Use a 5 mm Hex wrench to tighten the Wheel Shaft and tighten both screw A and screw B to 6 Nm. Tighten screw A before screw B.

## **Caution!**

*Ensure that all screws are tightened to the correct torque and that nothing fouls or restricts movement of the front fork when the suspension is fully compressed or extended. Please check suitable clearance between the fork and frame when turning.*

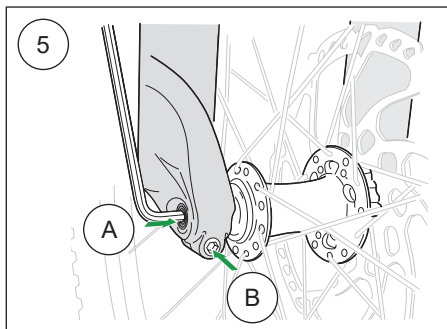
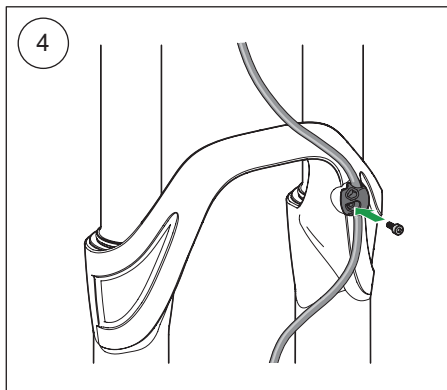

# 3 AIR SPRING SETUP

*A correct spring setup is the most important part of setting up your fork. Start with the recommended pressure and sag and go through the tuning steps described below. A poorly setup air spring can never be fully compensated by adjusting your damping system.*

## **Note!**

*For a more progressive spring characteristics contact an Authorized Öhlins MTB Service Center.*

Setting sag is a crucial part of setting your bicycle since it affects the height of the bicycle and the fork angle. In the following chapter we will describe how to set the sag. Please check pressure recommendations printed on the fork.

## **Note!**

*This procedure must be performed on a flat surface. Do not jump or bounce on your bicycle as it will result in an inaccurate sag measurement.*

### **Setting sag:**

**1**

Unscrew the cap to the lower valve (ramp up chamber) and assemble the air pressure pump. Pump to desired pressure. Disconnect the pump and put the cap back on.

**2**

Unscrew top air cap (Main chamber) and assemble the air pump. Pump to desired pressure. Disassemble the air pump and reinsert the compression air cap.

**3**

Set the O-ring (sag indicator) at the position according to illustration.

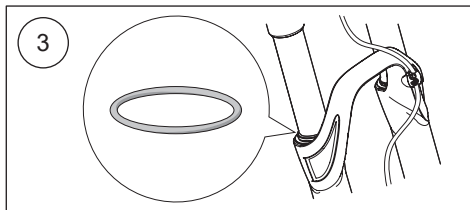
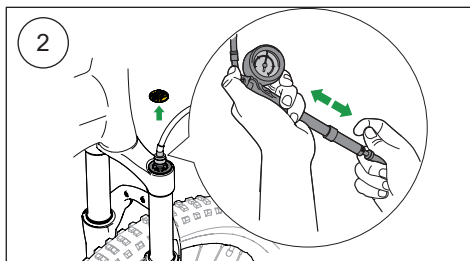
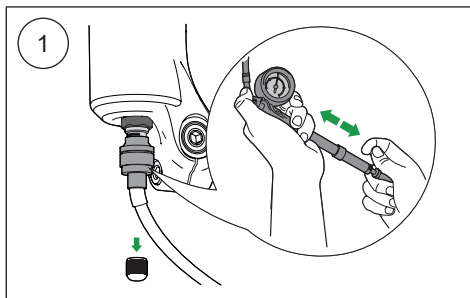

# 3 AIR SPRING SETUP

4

Dressed in full riding gear assume normal riding position on the bicycle.

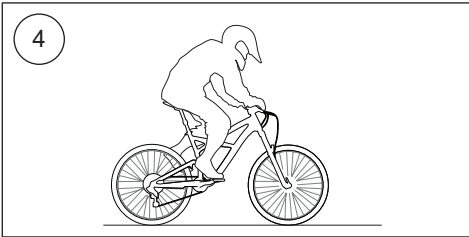

5

Step off the bicycle and measure the distance the O-ring (sag indicator) has moved. Sag should be set to approximately 10-15 % of the fork travel.

**General recommendations:**

- too little sag: release air from main chamber
- too much sag: fill up with more air in main chamber

**General recommendations:**

Heavy hard charging rider may require less sag while a smoother rider may benefit from more sag. If you have any questions, contact an Authorized Öhlins MTB Service Center for advice.

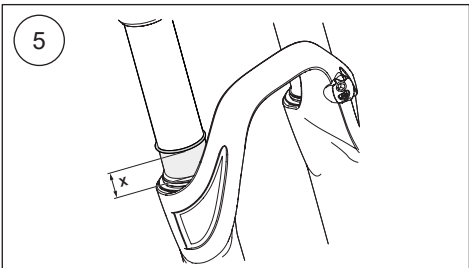

Rider weight	Main chamber	Ramp up chamber
50-60 kg (110-132 lbs)	70-80 psi	160-170 psi
60-70 kg (132-154 lbs)	80-90 psi	170-180 psi
70-80 kg (154-176 lbs)	90-100 psi	180-190 psi
80-90 kg (176-198 lbs)	100-110 psi	190-200 psi
90-100 kg (198-220 lbs)	110-120 psi	200-210 psi
100-110 kg (220-243 lbs)	120-130 psi	210-220 psi
110-120 kg (243-265 lbs)	130-140 psi	220-230 psi

# 3 AIR SPRING SETUP

## Reset to original ride position

After reducing the air pressure in the main chamber, it is necessary to reset the fork to its original length.

*Example:* If you are lowering the pressure from 130 psi to 80 psi, the fork will get a lower ride position (shorter travel). Reset the fork to original Ride position by extending the fork by pulling the handlebar up, while your friend is holding the wheel tight to the ground. Repeat the extension about 10 cycles, until you have reached the original length.

Original fork lengths:

Fork travel [mm]	Wiper seal to crown [mm]	Axle to crown [mm]
160	162	573
170	172	583
180	182	593

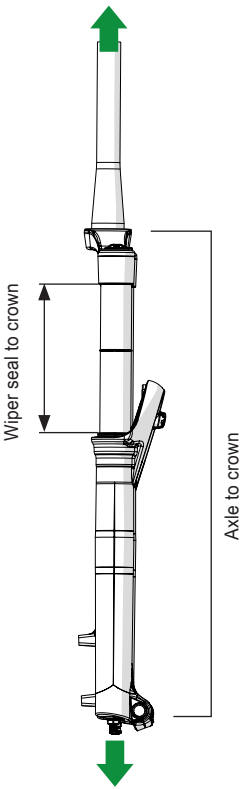

## 4 COIL SPRING SETUP

Setting sag is a crucial part of setting up your bicycle since it affects the height of the bicycle and the fork angle. In the following chapter we will describe how to set the sag.

### **Note!**

*This procedure must be performed on a flat surface. Do not jump or bounce on your bicycle as it will result in an inaccurate sag measurement.*

### **Setting sag:**

**1**

Turn the preload adjuster knob anticlockwise towards minus until it stops (minimum preload position).

**2**

Set the O-ring (sag indicator) at the position according to illustration.

**3**

Dressed in full riding gear assume normal riding position on the bicycle.

### **Note!**

*To change stroke, see instruction on [www.ohlins.com](http://www.ohlins.com)*

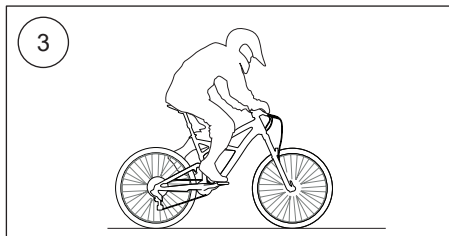
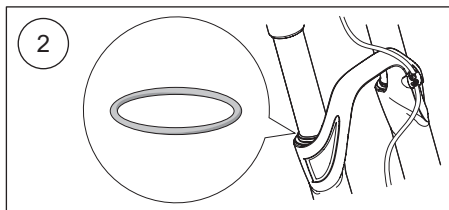
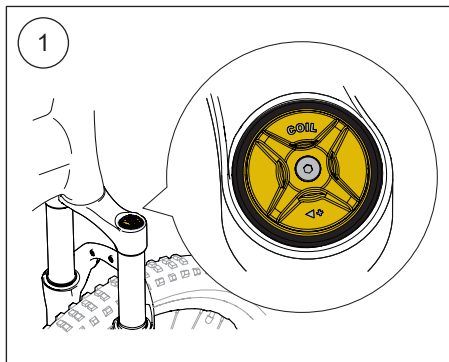

# 4 COIL SPRING SETUP

4

Step off the bicycle and measure the distance the O-ring (sag indicator) has moved. Sag should be set to approximately 15-20 % of the fork travel.

## General recommendations:

- Too little sag: turn the preload adjuster knob clockwise towards MINUS.
- Too much sag: turn the preload knob clockwise towards PLUS.

## General recommendations:

Heavy hard charging rider may require less sag while a smoother rider may benefit from more sag. If you have any questions, contact an Authorized Öhlins MTB Service Center for advice.

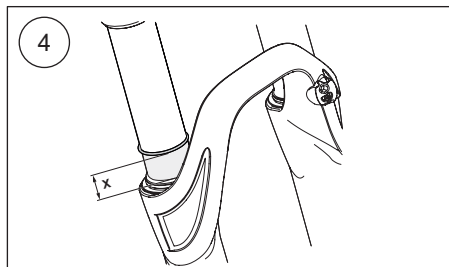

Spring rate [N/mm]	Tube color	Rider weight (kg)	Part no
7.0	Yellow (3x)	55	19286-01
7.9	Green (3x)	64	19286-02
8.8	Blue (3x)	72	19286-03
9.7	White (3x)	82	19286-04*
10.6	Black (3x)	91	19286-05
11.5	Red, Black, Red	100	19286-06
12.4	Yellow, Black, Yellow	109	19286-07

\* Standard AM fork

## 👁 Note!

*To achieve correct sag it may be necessary to change coil spring. Contact an Öhlins dealer for more information. See spring rate chart above.*

# 5 DAMPER SETUP

*Compression damping controls the energy absorption when the front fork is being compressed, thus controls how easily the front fork compresses when you hit a bump. Rebound damping controls the energy absorption when the front fork is being extended and controls how fast the front fork returns to its normal position after being compressed.*

## To set the adjusters

Turn the adjuster clockwise to fully closed position. Then, turn counter clockwise to open, and count the clicks until you reach the recommended number of clicks.

### ⚠ Caution!

Turn gently not to damage delicate sealing surfaces.  
Tighten with your hand only.

## Compression damping adjuster

### 1. Adjust low speed

To adjust, turn the blue coloured adjuster on the top of the TTX cartridge. Turn clockwise to increase damping, turn counter clockwise to decrease.

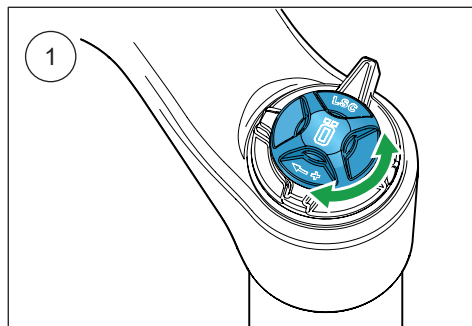

### 2. Adjust high speed

To adjust, turn the black coloured adjuster on the top of the TTX cartridge. Turn clockwise to increase damping, turn counter clockwise to decrease. For additional platform control, turn to fully closed (position 0 [zero]).

### 👁 Note!

Position 0 [zero]: Additional platform control is designed to be used for long climbs and not for normal riding. If used for normal riding you may experience loss of traction and bump absorption.

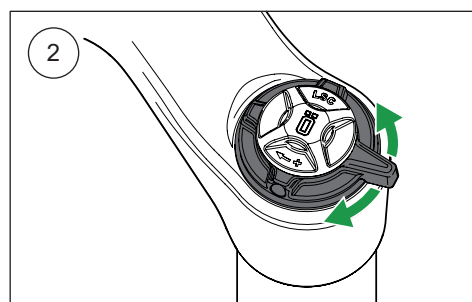

## Rebound damping adjuster

### 3. Adjust rebound

Turn the gold coloured adjuster on the end eye/ bracket. Turn clockwise to increase damping, turn counter clockwise to decrease.

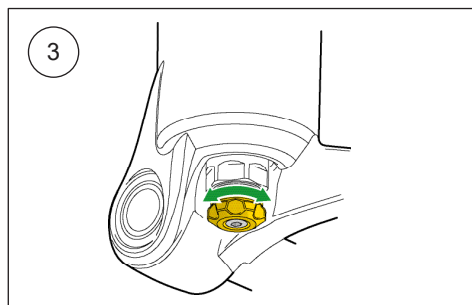

# 5 DAMPER SETUP

## Stability and traction

All bicycles are designed with a suspension geometry that include height and fork angle. Changing any components may affect the suspension geometry and it is therefore essential that the front and rear ends match each other. Changing to Öhlins suspension gives optimum performance only when both the front fork and the rear suspension interact properly. It is very important that the front and the rear ride heights are within the specified values.

## General setup

By adjusting the front fork and testing by trial and error you can learn how the different settings affect your bicycle. Always begin your setup process by taking a test ride with all adjustments at their recommended basic settings. Choose a short run of varying character, for example with long as well as sharp bends, hard and soft bumps. Stay on the same run and adjust only one setting at a time.

When you set up your bicycle you need to do it together with the front fork and on all types of tracks that you want to optimize, there are no setups that will be 100% perfect on all tracks, some compromises will need to be made.

Always keep priority at

- safe feeling
- stability
- comfort

This will allow you to ride safer, with more confidence and use less energy.

## Adjustment range

The RXF fork is designed for use within the full adjustment range, and using the front fork fully open or closed is normal for some riders.

## Rebound damping

If the bike feels loose, nervous over bumpy sections and kicking in jumps, close the rebound adjuster one click.

If the bicycle feels hard, harsh (no comfort), packs down under bumps and is difficult to enter corners with or does not stay in line over bumpy sections, decrease the rebound adjuster 1 click.

If the bicycle feels

- unstable
  - loose
  - bouncy
- Increase rebound damping

If the bicycle feels

- hard
  - nervous
  - low traction
- Decrease rebound damping

# 5 DAMPER SETUP

## Low speed compression damping

The low speed adjuster is used for controlling the chassis movement towards the ground.

If you feel that the front fork feels soft, spongy, or the bicycle feels unstable (for example when going into a corner), close 1 click (clockwise).

If you feel that the bicycle feels hard and has poor traction, open 1 click (counter-clockwise).

## High speed compression damping

The high speed adjuster has four positions. When the adjuster is fully closed it has position 0 [zero] and when the adjuster is fully open it has position 3.

Turn clockwise to increase the high speed damping and make the fork firmer. Turn counter clockwise to reduce the high speed damping.

Position 1-3 is suitable for trail riding.

Position 0 [zero] is for those long climbs where the need for traction is limited and additional platform control helps to gain efficiency.

If the bicycle feels

- soft
  - low
  - is bottoming
- Increase compression damping

If the bicycle feels

- harsh
  - hard
- Decrease compression damping

## 6 MAINTENANCE

Extreme riding in adverse weather conditions or lack of cleaning will shorten service intervals.

Maintenance	Interval
Clean dirt and debris from front fork	Every ride
Check air pressure and set sag (Air spring forks)	Every ride
Check torque on front fork mounting bolts	Every ride
Remove lowers, clean and inspect bushings and seals, change oil bath if necessary	50 hours
Replace coil spring protective tubes and regrease coil spring (Coil spring forks)	50 hours
Full front fork air spring service	100 hours/1 year
Remove and clean lowers, replace seals and bump rubbers, change oil bath	100 hours/1 year
Full front fork damping cartridge service	100 hours/1 year

# 7 SERVICE

Hours/Years	Lower service	Spring service	Damper service	Date	Comment
50h					
100h or 1 year					
150h					
200h or 2 years					
250h					
300h or 3 years					
350h					
400h or 4 years					
450h					
500h or 5 years					
550h					
600h or 6 years					
650h					
700h or 7 years					
750h					
800h or 8 years					





Your Öhlins retailer:

Öhlins Racing AB  
Box 722  
SE-194 27, Upplands Väsby  
Sweden

Phone: +46 (0)8 590 025 00  
Fax: +46 (0)8 590 025 80  
[www.ohlins.com](http://www.ohlins.com)



[www.ohlins.com](http://www.ohlins.com)