

Before installing this product, check the contents of the kit. If anything is missing, please contact an Öhlins dealer.

Kit Contents

	Part No	Pcs
Shock absorber	KA927/928	1pair
Sticker Öhlins	00192-01	2
Sticker "Memo notes"	01180-01	1
Tool preload adjuster	03199-03	1
Owner's manual	07241-02	1

Please note that during storage and transportation, especially at high ambient temperature, some of the oil and grease used for assembling may leak and stain the packaging. This is in no way detrimental to the product, wipe off the excessive oil/grease with a cloth.

⚠ Warning!

Before installing this product, read the Öhlins Owner's Manual. The shock absorber is an important part of your vehicle and will affect the stability.

Shock Absorber for Kawasaki ZRX 1200 DAEG

KA 927/928

Mounting Instructions



How to install

⚠ Warning!

It is advisable to have an Öhlins dealer install the shock absorber.

When installing, consult your Vehicle Service Manual.



1

Put the motorcycle on a workstand so that the rear wheel barely touches the ground.

⚠ Warning!

Make sure the vehicle is securely supported so that it will not tip.

2

Remove the original shock absorber. See the vehicle service manual for correct procedure.

👁 Note!

Before installing the Öhlins shock absorber clean the vehicle thoroughly.

3

Install the Öhlins shock absorber
- cylinder head up
- piggy pack reservoir towards rear

Use seals and spacers provided in this kit for the upper attachment.

👁 Caution!

There is a left and a right hand side shock absorber. The reservoir mount is slightly angled out towards the left/right side. Do not install the shock absorber with the reservoir angled towards the wheel side since the reservoir can be damaged.

👁 Note!

Lower the motorcycle so that the shock absorber is slightly compressed, before tightening the screws.

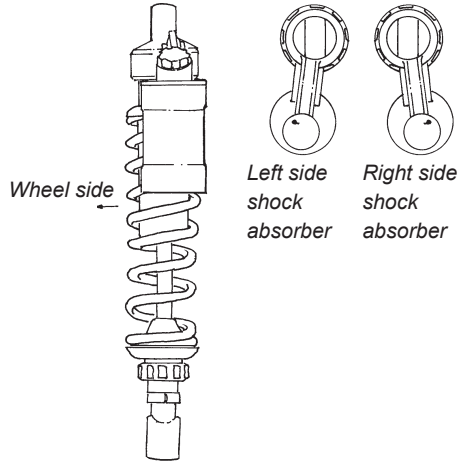

👁 Caution!

Make sure that all screws are tightened to the correct torque and that nothing fouls or restricts movement of the shock absorber when the suspension is fully compressed or extended.

4

Make sure that all removed parts are reinstalled in the same way as they were before the installation of the Öhlins shock absorber.

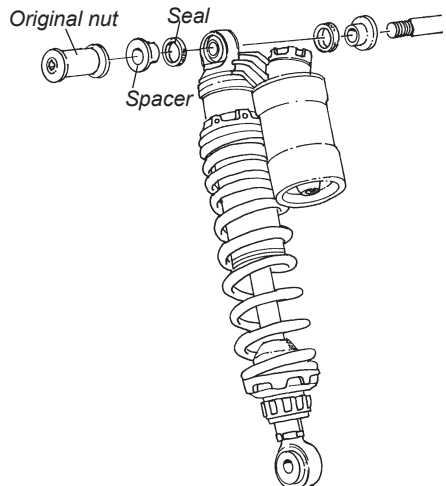

⚠ Warning!

Before riding, always make sure that the basic settings made by Öhlins are according to recommended Set-up Data. Read about adjustments and setting up in the Öhlins Owner's Manual before you make any adjustments. Contact an Öhlins dealer if you have any questions about setting up the shock absorber.

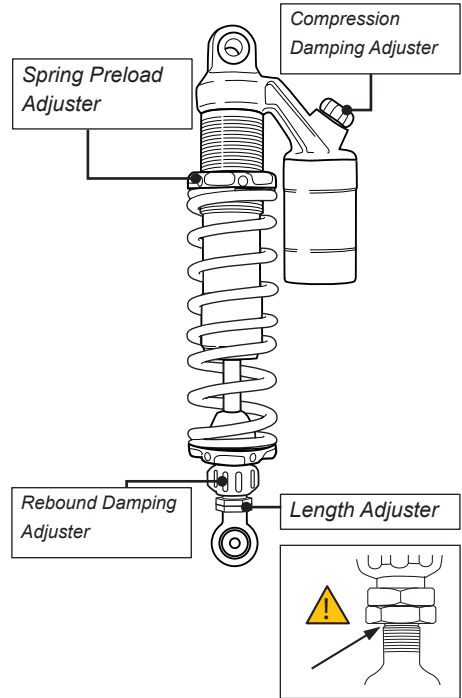

Set-up Data

Recommended set-up

Compression	15 clicks
Rebound	20 clicks
Spring Preload	19 mm

Shock absorber data

Length	377 ⁺⁶ / ₋₄ mm
Stroke	92

👁️ Öhlins products are subject to continuous improvement and development, therefore, although these instructions include the most up-to-date information available at the time of printing, minor updates may occur.

To find the latest information contact your Öhlins distributor. Please consult your Öhlins dealer if you have any questions regarding the contents in this document.

Part no. KA927_928_2
Issued 2014-03-10

© Öhlins Racing AB. All rights reserved. Any reprinting or unauthorized use without the written permission of Öhlins Racing AB is prohibited.

Öhlins Racing AB
Box 722
S-194 27 Upplands Väsby, Sweden
Phone +46 8 590 025 00
fax +46 8 590 025 80



www.ohlins.com