



#### **Note!**

Please note that there can be small differences between your product and the images in these instructions.

#### **Note!**

Please note that during storage and transport, especially at high ambient temperature, some of the oil and grease used for assembly may leak and stain the packaging. This will not cause damage to the product, wipe off the excessive oil or grease with a cloth.

#### **Kit Contents**

	Description	Part No	Pcs
1	Shock absorber		2
2	ABS cord bracket		2
3	Lock ring		4*
4	Spring platform		2*
5	Dust boot		2
6	Spring		2*
7	Lock nut M14		2

#### **Used for both front and rear**

8	C-spanner		1
9	C-spanner		1
10	Owner's manual		1
11	Sticker set R&T		1

\*Parts are mounted on the damper at delivery.

#### **Note!**

Before you install this product, check the kit contents. If anything is missing, please contact an Öhlins dealer.

#### **Warning!**

Before you install this product, read the Öhlins Owner's manual. This product is an important part of the vehicle and the vehicle stability.

Shock absorber for Porsche 911 Carrera (996)

# **POZ M100S1 FRONT**

## **Mounting Instructions**



# MOUNTING INSTRUCTIONS

## **⚠ Warning!**

We strongly recommend to let an Öhlins dealer install this product.

## **⚠ Warning!**

If you work with a lifted vehicle, make sure that it is safely supported to prevent it from tipping over.

## **👁 Note!**

When you work with this product, see the vehicle service manual for vehicle specific procedures and important data.

## **👁 Note!**

Before you install this product clean the vehicle.

**1**

Remove the original shock absorbers from the vehicle, see the vehicle service manual for correct procedure.

**2**

Remove the top washer, top mount, bearing, rubber insulator and lower washer from the original strut.

## **👁 Note!**

You will need these parts to install the Öhlins strut.

## **👁 Note!**

See the vehicle service manual on how to remove the parts.

## **⚠ Warning!**

The spring is preloaded so take precaution when you remove the spring from the damper.

**3**

Cut the dust boot 20 mm from the lower end.

**4**

Assemble the strut/shock absorber, see figure 2.

Fig. 1

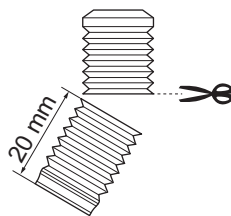
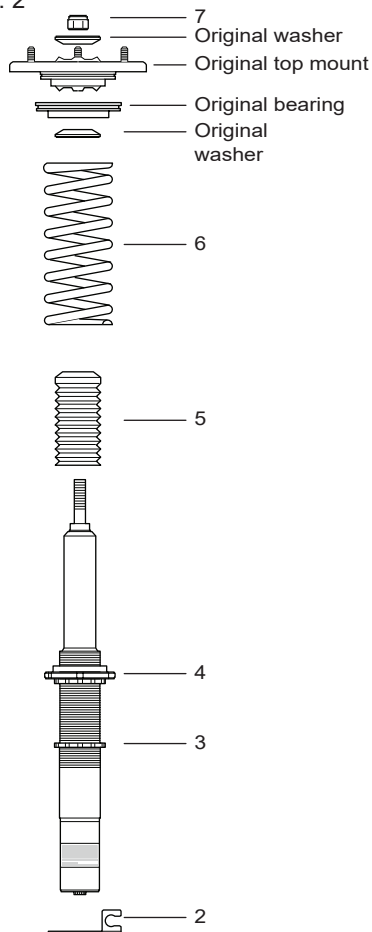

Fig. 2



# MOUNTING INSTRUCTIONS

## 5

Set the installation dimensions according to figure 3. You may need to change these to reach the target height.

### **Note!**

---

*After you have installed all shock absorbers/struts you must check and adjust height. See section Adjustments and Setup data.*

---

## 6

Install the Öhlins strut on the vehicle according to the vehicle service manual.

### **Caution!**

---

*Ensure that all screws are tightened to the correct torque and that nothing fouls or restricts movement of the strut/shock absorber when the suspension is fully compressed or extended.*

---

### **Note!**

---

*Make sure that all removed parts, except the replaced parts, are reinstalled in the same positions as they were before the installation of the Öhlins shock absorbers.*

---

# ADJUSTMENTS

## ⚠ Warning!

*Before riding, always make sure that the basic settings made by Öhlins are according to recommended Setup Data. Read about adjustments and setting up in the Öhlins Owner's Manual before you make any adjustments. Contact an Öhlins dealer if you have any questions about setting up.*

The standard preload is 5 mm from a free length of 200 mm, giving 195 mm installed length, see fig 3.

# SETUP DATA

## Recommended set-up

Setting adjustment		
Track use	0-7	clicks
Winding road	5-10	clicks
Street	10-20	clicks
Spring preload	5	mm

## Recommended spring

47070-15 (60 N/mm)

## The actual vehicle height

With the preload in its recommended position, the vehicle is lowered approximately 20 mm when compared to the original suspension. The adjustment range is approximately +0 to -30 mm ride height depending on car model, accessories and condition of OE suspension.

Fig. 3

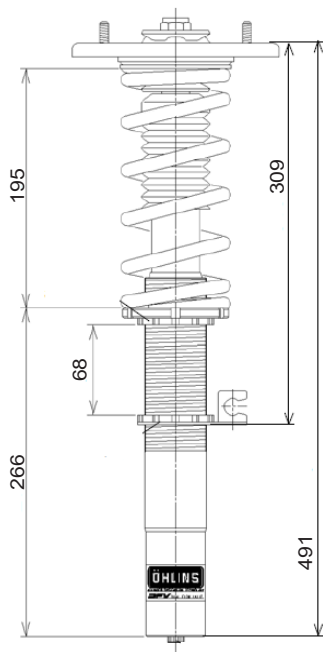

## Tighten:

Lower spring seat and lock ring: 50-60 Nm

Lock nut M14: 35-40 Nm

## 👁 Note!

*When you tighten the top mount nut, hold the strut top pin in position with a 6 mm Allen key*

Öhlins products are subject to continuous improvement and development, therefore, although these instructions include the most up-to-date information available at the time of printing, minor updates may occur.

To find the latest information contact an Öhlins distributor. Please contact Öhlins if you have any questions regarding the contents in this document.

Part no. MI\_POZMI00S1\_0  
Issued 2024-06-17

© Öhlins Racing AB. All rights reserved. Any reprinting or unauthorized use without the written permission of Öhlins Racing AB is prohibited.

Öhlins Racing AB  
Box 722  
S-194 27 Upplands Väsby, Sweden  
Phone +46 8 590 025 00  
fax +46 8 590 025 80



[www.ohlins.com](http://www.ohlins.com)



#### 👁 **Note!**

Please note that there can be small differences between your product and the images in these instructions.

#### 👁 **Note!**

Please note that during storage and transport, especially at high ambient temperature, some of the oil and grease used for assembly may leak and stain the packaging. This will not cause damage to the product, wipe off the excessive oil or grease with a cloth.

#### Kit Contents

	Description	Part No	Pcs
1	Shock absorber		2
2	Stabilizer bracket		2
3	Lock ring		4*
4	Spring platform		2*
5	Bump rubber		2*
6	Stop washer		2*
7	Dust boot		2
8	Plastic spacer		2
9	Spring		2
10	Washer		2
11	Elastic spacer		2
12	Upper spring seat		2
13	Lock nut M12		2
14	Adjuster		2*
15	Screw M6		4
16	Spacer		2

#### Used for both front and rear

8	C-spanner		1
9	C-spanner		1
10	Owner's manual		1
11	Sticker set R&T		1

\*Parts are mounted on the damper at delivery.

#### 👁 **Note!**

Before you install this product, check the kit contents. If anything is missing, please contact an Öhlins dealer.

#### ⚠ **Warning!**

Before you install this product, read the Öhlins Owner's manual. This product is an important part of the vehicle and the vehicle stability.

Shock absorber for Porsche 911 Carrera (996)

# **POZ M100S1 REAR**

## **Mounting Instructions**



# MOUNTING INSTRUCTIONS

## **⚠ Warning!**

*We strongly recommend to let an Öhlins dealer install this product.*

## **⚠ Warning!**

*If you work with a lifted vehicle, make sure that it is safely supported to prevent it from tipping over.*

## **👁 Note!**

*When you work with this product, see the vehicle service manual for vehicle specific procedures and important data.*

## **👁 Note!**

*Before you install this product clean the vehicle.*

**1**

Remove the original shock absorbers from the vehicle, see the vehicle service manual for correct procedure.

**2**

Remove the top washer, top mount and lower washer from the original damper.

## **👁 Note!**

*You will need these parts to install the Öhlins shock absorber.*

## **👁 Note!**

*See the vehicle service manual on how to remove the parts.*

## **⚠ Warning!**

*The spring is preloaded so take precaution when you remove the spring from the damper.*

**3**

Cut the dust boot 50 mm from the lower end.

**4**

Assemble the strut/shock absorber, see figure 2.

Fig. 1

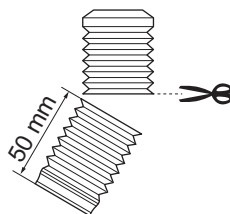
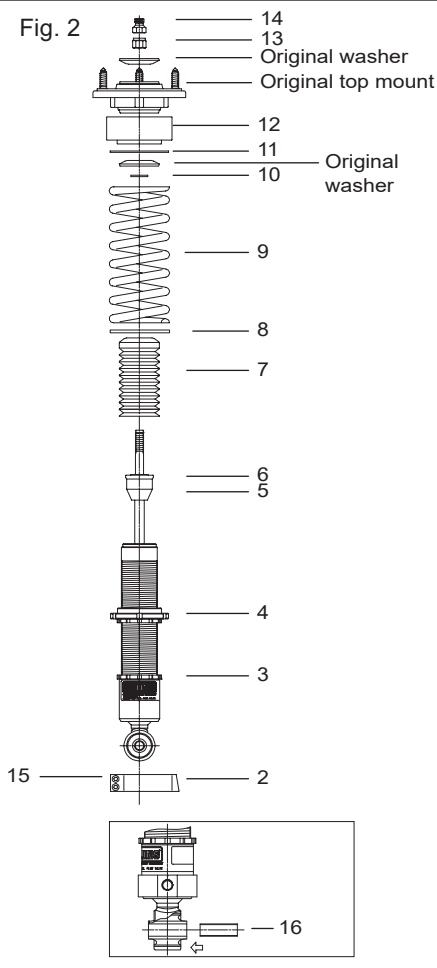

Fig. 2



# MOUNTING INSTRUCTIONS

## 5

Set the installation dimensions according to figure 4. You may need to change these to reach the target height.

### **Note!**

*After you have installed all shock absorbers/struts you must check and adjust height. See section Adjustments and Setup data.*

## 6

Install the Öhlins shock absorber on the vehicle according to the vehicle service manual.

### **Caution!**

*Ensure that all screws are tightened to the correct torque and that nothing fouls or restricts movement of the strut/shock absorber when the suspension is fully compressed or extended.*

### **Note!**

*Make sure that all removed parts, except the replaced parts, are reinstalled in the same positions as they were before the installation of the Öhlins shock absorbers.*

## 7

Position the anti roll bar bracket according to figure 3.

## 8

If the car is equipped with the BOSE loud speaker system you will need a wire adjuster.  
Part numbers:

24631-01 (1 pc/side)

24632-01 (1 pc/side)

24633-01 (1 pc/side)

24633-02 (1 pc/side)

### **Note!**

*Parts for step 8 need to be ordered separately.*

Fig. 3

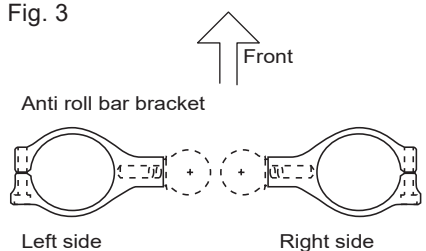

# ADJUSTMENTS

## ⚠ Warning!

*Before riding, always make sure that the basic settings made by Öhlins are according to recommended Setup Data. Read about adjustments and setting up in the Öhlins Owner's Manual before you make any adjustments. Contact an Öhlins dealer if you have any questions about setting up.*

The standard preload is 5 mm from a free length of 200 mm, giving 195 mm installed length, see fig 4.

# SETUP DATA

## Recommended set-up

Setting adjustment		
Track use	0-7	clicks
Winding road	5-10	clicks
Street	10-20	clicks
Spring preload	5	mm

## Recommended spring

47010-39 (120N/mm)

## The actual vehicle height

With the preload in its recommended position, the vehicle is lowered approximately 20 mm when compared to the original suspension. The adjustment range is approximately +0 to -30 mm ride height depending on car model, accessories and condition of OE suspension.

Fig. 4

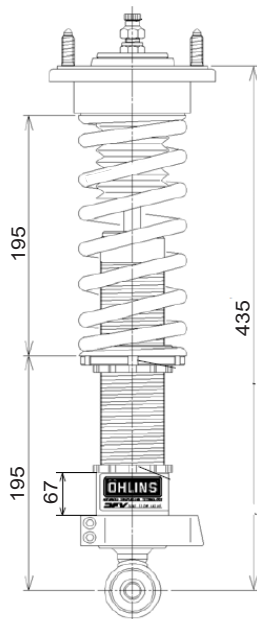

## Tighten:

Lower spring seat and lock ring: 50-60 Nm  
Lock nut M12: 30-35Nm  
Anti roll bar bracket screw M6: 12-15 Nm

## 👁 Note!

*When you tighten the top mount nut, hold the shock absorber shaft in position with a flat screwdriver.*

Öhlins products are subject to continuous improvement and development, therefore, although these instructions include the most up-to-date information available at the time of printing, minor updates may occur.

To find the latest information contact an Öhlins distributor. Please contact Öhlins if you have any questions regarding the contents in this document.

Part no. MI\_POZMI00S1\_0  
Issued 2024-06-17

© Öhlins Racing AB. All rights reserved. Any reprinting or unauthorized use without the written permission of Öhlins Racing AB is prohibited.

Öhlins Racing AB  
Box 722  
S-194 27 Upplands Väsby, Sweden  
Phone +46 8 590 025 00  
fax +46 8 590 025 80



[www.ohlins.com](http://www.ohlins.com)