



#### Kit Contents

	Description	Part No	Pcs
1	Shock absorber	POS 5N11	2
2	Lock ring	00533-21	4
3	Spring seat	05018-11	2
4	Plastic spacer	25602-01	4
5	Dust boot	10216-01	2
6	Helper spring	05173-20	2
7	Spring support	05139-13	2
8	Spring	48010-27	2
9	Upper spring seat	25600-03	2
10	C-spanner	00710-02	2
11	Öhlins sticker kit	10207-01	1
12	Öhlins Owners manual		1

#### 👁 Note!

Please note that there can be small differences between your product and the images in these instructions.

#### 👁 Note!

Please note that during storage and transport, especially at high ambient temperature, some of the oil and grease used for assembly may leak and stain the packaging. This will not cause damage to the product, wipe off the excessive oil or grease with a cloth.

#### 👁 Note!

Before you install this product, check the kit contents. If anything is missing, please contact an Öhlins dealer.

#### ⚠ Warning!

Before you install this product, read the Öhlins Owner's manual. This product is an important part of the vehicle and the vehicle stability.

#### 👁 Note!

If the vehicle is equipped with OE electronic shock absorbers, use Öhlins cancellation kit. See products news for part number.

Shock absorber for Porsche 911 GT3/GT3 RS/GT2 (997)

# **POZ MN04S1 FRONT**

## Mounting Instructions



# MOUNTING INSTRUCTIONS

## **⚠ Warning!**

*It is advisable to have an Öhlins dealer install the shock absorber/front fork/steering damper.*

## **⚠ Warning!**

*If working on a raised vehicle, ensure it is securely supported so that it will not tip.*

## **👁 Note!**

*When working on this product, always see the Vehicle Service Manual for vehicle specific procedures and important data.*

**1**

Raise the vehicle, use jack stands.

**2**

Remove the front wheels.

## **👤 Caution!**

*Support the wheel hubs on each side of the vehicle not to damage the brake hoses.*

**3**

Remove the anti roll bar link, brake hose attachment and PASM wires, if any.

**4**

Remove the brake caliper and support it not to damage the brake hose.

**5**

Loosen the lower and upper strut attachment bolts. Remove the original struts from the vehicle.

**6**

Cut the dust boot 62 mm from the lower end according to the figure.

Fig. 1

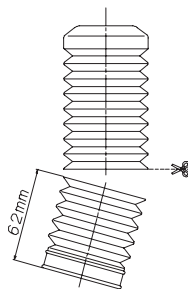

# MOUNTING INSTRUCTIONS

7

Assemble the shock absorber according to Fig 2. Install the two lock rings (2), the spring seat (3), the plastic spacer (4), the dust boot (5), the helper spring (6), the spring support (7), the main spring (8), the plastic spacer (4) and the upper spring seat (9). Install the OEM spacer, the OEM top mount and the OEM nut. Tighten the nut to OE specifications.

## **Note!**

*Set the spring preload and lower lock nut position according to figure 3. Tighten the lower spring seat and the lock ring to 50-60Nm.*

8

Raise the wheel hub with a jack to ensure that the height adjuster is correctly seated on top of the hub carrier/upright. Tighten the upright bolt to OE specifications.

9

Tighten the lower lock nut (at upright) to 35-40Nm.

## **Note!**

*When tightening the top mount nut, the shock absorber shaft must be held in position with a 6 mm Allen key.*

## **Caution!**

*Ensure that all screws are tightened to the correct torque and that nothing fouls or restricts movement of the shock absorber/front fork/steering damper when the suspension is fully compressed or extended.*

11

Make sure that all removed parts are reinstalled in the same way as they were before the installation of the Öhlins shock absorbers.

Fig. 2

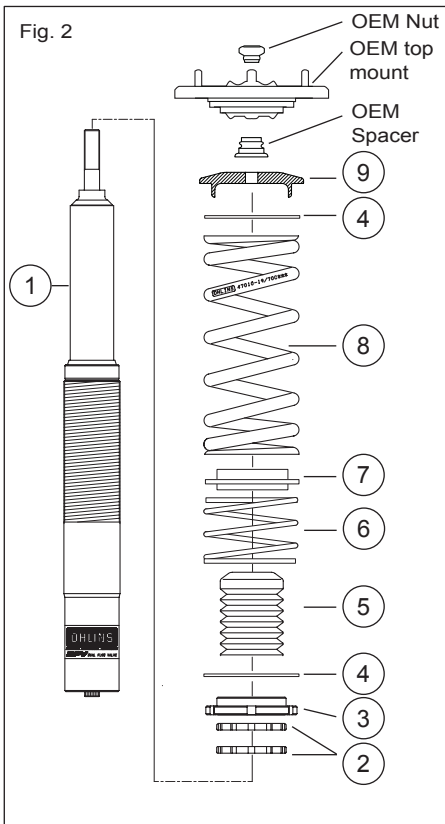

# ADJUSTMENTS

## ⚠ Warning!

Before driving, always make sure that the basic settings made by Öhlins are according to recommended Set-up Data. Read about adjustments and setting up in the Öhlins Owner's Manual before you make any adjustments. Contact an Öhlins dealer if you have any questions about setting up the shock absorber.

The installed spring length is 228 mm. Measure from upper part of main spring to lower part of helper spring.

## SETUP DATA

### Recommended set-up

Rebound setting		
Track	0-7	clicks
Winding road	5-10	clicks
Street	10-20	clicks
Installed spring length	228	mm

### Recommended spring

Main spring: 48010-27 (90 N/mm)

Helper spring: 05173-20

### The actual vehicle height

With the spring preload adjuster and height adjuster set to the recommended position, the vehicle is lowered approximately 5 mm when compared to the original suspension. Depending on car model and equipment, the spring preload and vehicle height may vary. As the preload or height adjuster is turned one rotation, the position moves 1.5 mm. Adjust the

Fig. 3

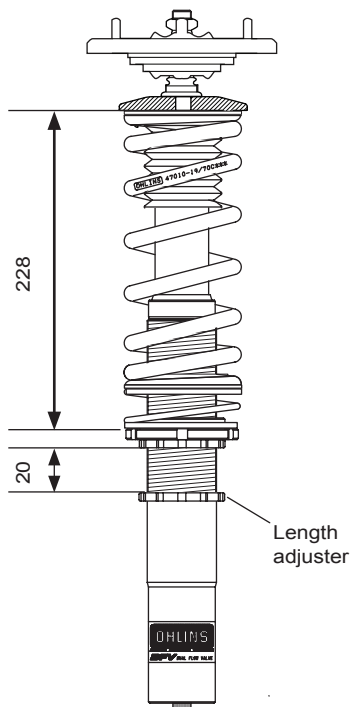

spring preload or height adjuster until you have reached your desired ride height. Make sure that the spring is always preloaded.

## ⚠ Warning!

The length adjuster range is  $\pm 10$  mm.

Öhlins products are subject to continuous improvement and development, therefore, although these instructions include the most up-to-date information available at the time of printing, minor updates may occur.

To find the latest information contact an Öhlins distributor. Please contact Öhlins if you have any questions regarding the contents in this document.

Part no. MI\_POZMN04S1\_front  
Issued 2024-01-15

© Öhlins Racing AB. All rights reserved. Any reprinting or unauthorized use without the written permission of Öhlins Racing AB is prohibited.

Öhlins Racing AB  
Box 722  
S-194 27 Upplands Väsby, Sweden  
Phone +46 8 590 025 00  
fax +46 8 590 025 80



[www.ohlins.com](http://www.ohlins.com)



#### Kit Contents

	Description	Part No	Pcs
1	Shock absorber	POS 6N20	2
2	Lock nut	00533-21	4
3	Spring seat	05018-11	2
4	Dust boot	24631-01	2
5	Spacer	24629-19	2
6	Plastic spacer	25601-01	2
7	Spring	48010-47	2
8	Upper spring seat	25602-01	2
9	Washer	24619-08	2
10	Lock nut	24618-04	2
11	Adjuster knob	24631-02	2

#### 👁 Note!

Please note that there can be small differences between your product and the images in these instructions.

#### 👁 Note!

Please note that during storage and transport, especially at high ambient temperature, some of the oil and grease used for assembly may leak and stain the packaging. This will not cause damage to the product, wipe off the excessive oil or grease with a cloth.

#### 👁 Note!

Before you install this product, check the kit contents. If anything is missing, please contact an Öhlins dealer.

#### ⚠ Warning!

Before you install this product, read the Öhlins Owner's manual. This product is an important part of the vehicle and the vehicle stability.

#### 👁 Note!

If the vehicle is equipped with OE electronic shock absorbers, use Öhlins cancellation kit. See products news for part number.

Shock absorber for Porsche 911 GT3/GT3 RS/GT2 (997)

# **POZ MN04S1 REAR**

## Mounting Instructions



# MOUNTING INSTRUCTIONS

## **⚠ Warning!**

*It is advisable to have an Öhlins dealer install the shock absorber/front fork/steering damper.*

## **⚠ Warning!**

*If working on a raised vehicle, ensure it is securely supported so that it will not tip.*

## **👁 Note!**

*When working on this product, always see the Vehicle Service Manual for vehicle specific procedures and important data.*

**1**

Raise the vehicle, use jack stands.

**2**

Remove the rear wheels. Remove the carpeting section behind the rear seat to reach the upper shock absorber attachments.

**3**

Remove the lower and upper attachments and remove the original shock absorbers.

**4**

Cut the dust boot 82 mm from the lower end according to figure 1.

**5**

Assemble the shock absorber according to Fig 2. Install the two lock rings (2), the spring seat (3), the dust boot (4), the rubber spacer, the spacer (5), the plastic spacer (6), the spring (7), the plastic spacer (6), the upper spring seat (8), the OEM top mount, the washer (9) and the lock nut (10). Tighten the lock nut to 30Nm and install the rebound adjuster (11) and tighten that to 10 Nm.

## **👁 Note!**

*Install the boot between the rubber spacer and the bump stop. See figure 2b.*

## **👁 Note!**

*Set the spring preload and lower lock nut position according to figure 3. Tighten the lower spring seat and the lock ring to 50-60Nm. Set the length adjuster position according to Figure 3. Tighten the lock ring to 50-60 Nm.*

Fig. 1

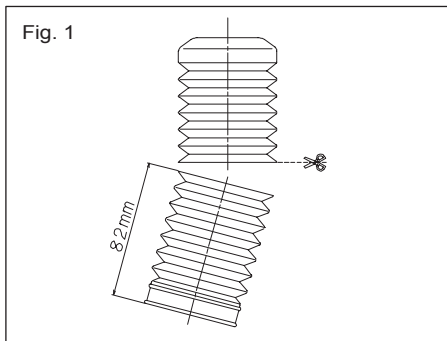
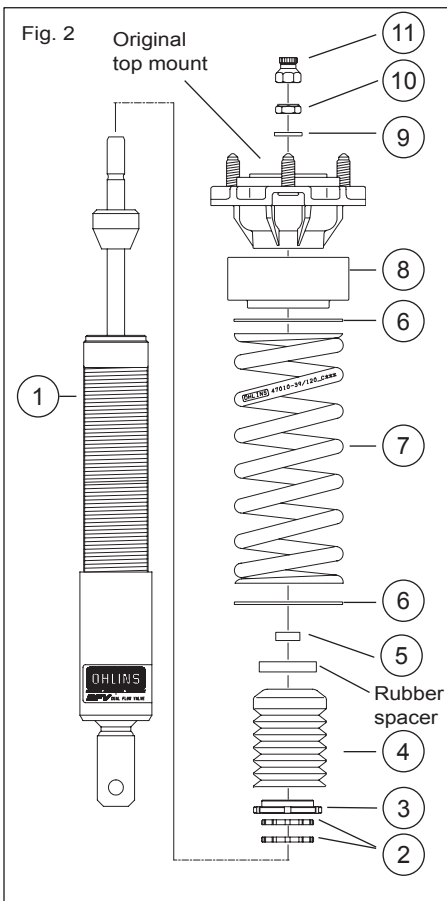

Fig. 2



# MOUNTING INSTRUCTIONS

## 👁 **Note!**

*When tightening the top mount nut, the shock absorber shaft must be held in position with a flat screwdriver.*

## 6

Install the Öhlins shock absorber to the vehicle.

## 👤 **Caution!**

*Ensure that all screws are tightened to the correct torque and that nothing fouls or restricts movement of the shock absorber/front fork/steering damper when the suspension is fully compressed or extended.*

## 7

Make sure that all removed parts are reinstalled in the same way as they were before the installation of the Öhlins shock absorbers.

Fig. 2b

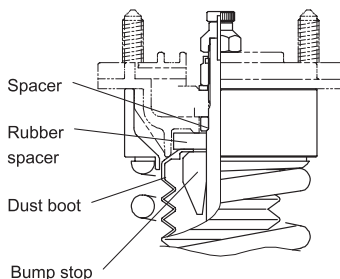

# ADJUSTMENTS

## ⚠ Warning!

*Before driving, always make sure that the basic settings made by Öhlins are according to recommended Set-up Data. Read about adjustments and setting up in the Öhlins Owner's Manual before you make any adjustments. Contact an Öhlins dealer if you have any questions about setting up the shock absorber.*

The preload is 2mm from a free length of 200 mm, giving 198 mm installed length, see fig 3

## SETUP DATA

### Recommended set-up

Rebound setting		
Track	0-7	clicks
Winding road	5-10	clicks
Street	10-20	clicks
Spring preload	2	mm

### Recommended spring

48010-47 (140N/mm)

### The actual vehicle height

With the spring preload adjuster and height adjuster set to the recommended position, the vehicle is lowered approximately 5 mm when compared to the original suspension. Depending on car model and equipment, the spring preload and vehicle height may vary. As the preload or height adjuster is turned one

Fig. 3

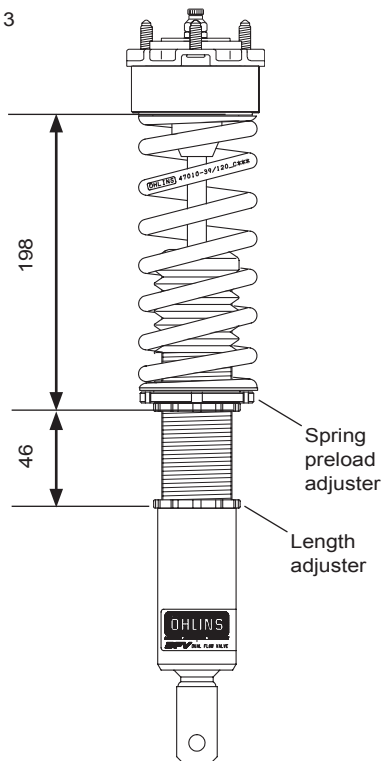

rotation, the position moves 1.5 mm. Adjust the spring preload or height adjuster until you have reached your desired ride height. Make sure that the spring is always preloaded.

## ⚠ Warning!

*Length adjustment range: Standard position -8 to +15 mm.*

Öhlins products are subject to continuous improvement and development, therefore, although these instructions include the most up-to-date information available at the time of printing, minor updates may occur.

To find the latest information contact an Öhlins distributor. Please contact Öhlins if you have any questions regarding the contents in this document.

Part no. MI\_POZMN04S1\_rear  
Issued 2024-01-15

© Öhlins Racing AB. All rights reserved. Any reprinting or unauthorized use without the written permission of Öhlins Racing AB is prohibited.

Öhlins Racing AB  
Box 722  
S-194 27 Upplands Väsby, Sweden  
Phone +46 8 590 025 00  
fax +46 8 590 025 80



[www.ohlins.com](http://www.ohlins.com)